



Breedte/Diepte/Hoogte/Zitdiepte/Zithoogte/Poot/Arm
(Tolerantie op afmetingen tot ±3%)

10

110/105/88/55/47/2,5/61
ZETEL
MANUELE HOOFDSTEUN



19

87/105/88/55/47/2,5/61
ZETEL SMAL - ARM L
MANUELE HOOFDSTEUN



11

97/105/88/55/47/2,5/61
ZETEL - ARM L
MANUELE HOOFDSTEUN



07

107/105/88/55/47/2,5/61
ZETEL BREED - ARM L
MANUELE HOOFDSTEUN



18

87/105/88/55/47/2,5/61
ZETEL SMAL - ARM R
MANUELE HOOFDSTEUN



12

97/105/88/55/47/2,5/61
ZETEL - ARM R
MANUELE HOOFDSTEUN



08

107/105/88/55/47/2,5/61
ZETEL BREED - ARM R
MANUELE HOOFDSTEUN

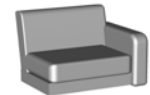

17

64/105/88/55/47/2,5/-
ZETEL SMAL - ZONDER ARMEN
MANUELE HOOFDSTEUN



15

74/105/88/55/47/2,5/-
ZETEL - ZONDER ARMEN
MANUELE HOOFDSTEUN



09

84/105/88/55/47/2,5/-
ZETEL BREED - ZONDER ARMEN
MANUELE HOOFDSTEUN



14E

110/105/88/55/47/2,5/61
RELAX ELECTRISCH
MANUELE HOOFDSTEUN



61E

87/105/88/55/47/2,5/61
RELAX ELEC. SMAL - ARM L
MANUELE HOOFDSTEUN



71E

97/105/88/55/47/2,5/61
RELAX ELEC. - ARM L
MANUELE HOOFDSTEUN



81E

107/105/88/55/47/2,5/61
RELAX ELEC. BREED - ARM L
MANUELE HOOFDSTEUN

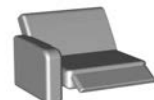

62E

87/105/88/55/47/2,5/61
RELAX ELEC. SMAL - ARM R
MANUELE HOOFDSTEUN



72E

97/105/88/55/47/2,5/61
RELAX ELEC. - ARM R
MANUELE HOOFDSTEUN

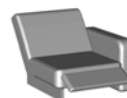

82E

107/105/88/55/47/2,5/61
RELAX ELEC. BREED - ARM R
MANUELE HOOFDSTEUN

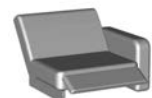

63E

64/105/88/55/47/2,5/-
RELAX ELEC. SMAL - ZND ARMEN
MANUELE HOOFDSTEUN



73E

74/105/88/55/47/2,5/-
RELAX ELEC. - ZND ARMEN
MANUELE HOOFDSTEUN



83E

84/105/88/55/47/2,5/-
RELAX ELEC. BREED - ZND ARMEN
MANUELE HOOFDSTEUN





Breedte/Diepte/Hoogte/Zitdiepte/Zithoogte/Poot/Arm
(Tolerantie op afmetingen tot ±3%)

24E

176/105/88/55/47/2,5/61
2 ZIT - RELAX ELEC L+R
MANUELE HOOFDSTEUN L+R

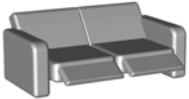

27E

176/105/88/55/47/2,5/61
2 ZIT - RELAX ELEC L
MANUELE HOOFDSTEUN L+R



28E

176/105/88/55/47/2,5/61
2 ZIT - RELAX ELEC R
MANUELE HOOFDSTEUN L+R

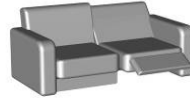

49E

196/105/88/55/47/2,5/61
2,5 ZIT - RELAX ELEC L+R
MANUELE HOOFDSTEUN L+R

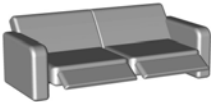

47E

196/105/88/55/47/2,5/61
2,5 ZIT - RELAX ELEC L
MANUELE HOOFDSTEUN L+R

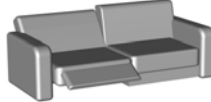

48E

196/105/88/55/47/2,5/61
2,5 ZIT - RELAX ELEC R
MANUELE HOOFDSTEUN L+R

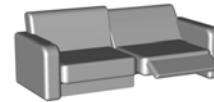

34E

240/105/88/55/47/2,5/61
3 ZIT - RELAX ELEC L+R
MANUELE HOOFDSTEUN L+M+R

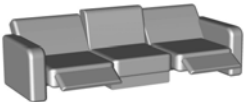

37E

240/105/88/55/47/2,5/61
3 ZIT - RELAX ELEC L
MANUELE HOOFDSTEUN L+M+R

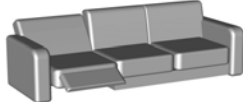

38E

240/105/88/55/47/2,5/61
3 ZIT - RELAX ELEC R
MANUELE HOOFDSTEUN L+M+R

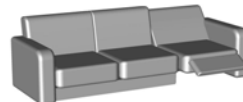



Breedte/Diepte/Hoogte/Zitdiepte/Zithoogte/Poot/Arm
(Tolerantie op afmetingen tot ±3%)

20

176/105/88/55/47/2,5/61
2 ZIT
MANUELE HOOFDSTEUN L+R



21

153/105/88/55/47/2,5/61
2 ZIT - ARM L
MANUELE HOOFDSTEUN L+R



22

153/105/88/55/47/2,5/61
2 ZIT - ARM R
MANUELE HOOFDSTEUN L+R



51

130/105/88/55/47/2,5/-
2 ZIT - ZONDER ARMEN
MANUELE HOOFDSTEUN L+R

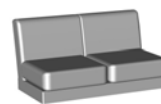

45

196/105/88/55/47/2,5/61
2,5 ZIT
MANUELE HOOFDSTEUN L+R

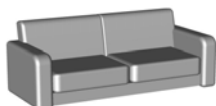

41

173/105/88/55/47/2,5/61
2,5 ZIT - ARM L
MANUELE HOOFDSTEUN L+R

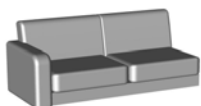

42

173/105/88/55/47/2,5/61
2,5 ZIT - ARM R
MANUELE HOOFDSTEUN L+R

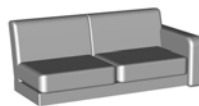

52

150/105/88/55/47/2,5/-
2,5 ZIT - ZONDER ARMEN
MANUELE HOOFDSTEUN L+R

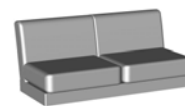

30

240/105/88/55/47/2,5/61
3 ZIT
MANUELE HOOFDSTEUN L+M+R

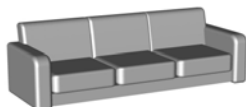

31

217/105/88/55/47/2,5/61
3 ZIT - ARM L
MANUELE HOOFDSTEUN L+M+R

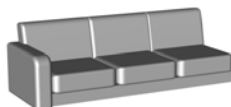

32

217/105/88/55/47/2,5/61
3 ZIT - ARM R
MANUELE HOOFDSTEUN L+M+R

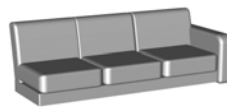

55

244/108/88/55/47/2,5/-
DORMEUSE - LINKS
2 MANUELE HOOFDSTEUNEN

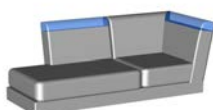

54

244/108/88/55/47/2,5/-
DORMEUSE - RECHTS
2 MANUELE HOOFDSTEUNEN

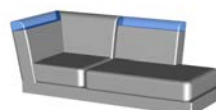

57

100/173/88/123/47/2,5/61
LONGCHAIR - ARM L
MANUELE HOOFDSTEUN

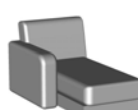

58

100/173/88/123/47/2,5/61
LONGCHAIR - ARM R
MANUELE HOOFDSTEUN

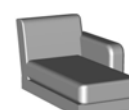

40

108/108/88/55/47/2,5/-
HOEK RECHT



40R

108/108/88/55/47/2,5/-
HOEK RECHT
MANUELE HOOFDSTEUN RECHTS



40L

108/108/88/55/47/2,5/-
HOEK RECHT
MANUELE HOOFDSTEUN LINKS

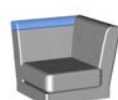

43

128/128/88/55/47/2,5/-
HOEK SCHUIN

